

Cable lugs > Pre-insulated > Cable terminals

Type: RF-PP12/1

Family: F-PP

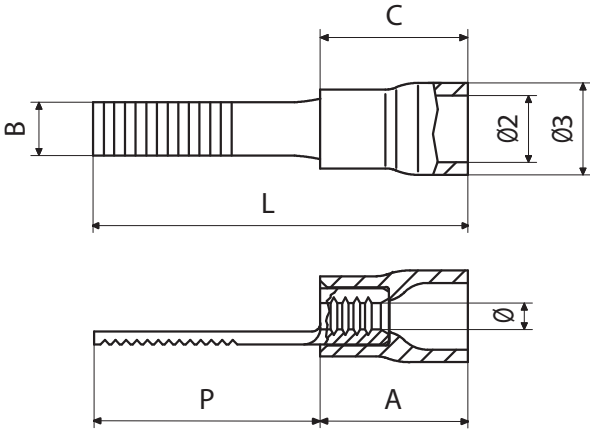

FLAT PIN TERMINAL, PRE-INSULATED WITH PVC, RED, FOR COPPER CONDUCTORS, P=11,3X3,0 SECTION 0,25-1,5 MMQ

Technical information	
Maximum operating temperature	75 °C
Minimum operating temperature	-20 °C
Cable section range	0.25÷1.5 mm²
Colour of jacket	Red
Cable stripping length	4.6 mm
Presence of reinforcement ring	No
Easy entry	Yes
Anti-vibration	No
Type	single
Insulation type	partial
Tip type	blade

Weight and dimensions	
Bow external diameter (Ø3)	5.5 mm
Barrel internal diameter (Ø)	1.8 mm
Bow internal diameter (Ø2)	4 mm
Tip width (B)	3 mm
Barrel length (A)	4.2 mm
Tip length (P)	11.3 mm
Sleeve length (C)	10.1 mm

Weight and dimensions	
Total connector length (L)	21.3 mm

Material composition and treatments	
Halogen-free	No
Insulating jacket material	Polyvinylchloride PVC
Conductor body material	Electrolytic copper with purity above 99,95%
Annealed	Yes

Certifications and approvals	
Marks	UL (cULus)
UL 94 self-extinguishing class	V0
Reference standards	UL 486A-486B;UL 486C
REACH	Yes
ROHS	Yes

Logistics	
Minimum packaging unit	100
Standard packaging unit	3000