

Cable lugs > Pre-insulated > Connector sleeves

Type: NL06-P

Family: NL-P

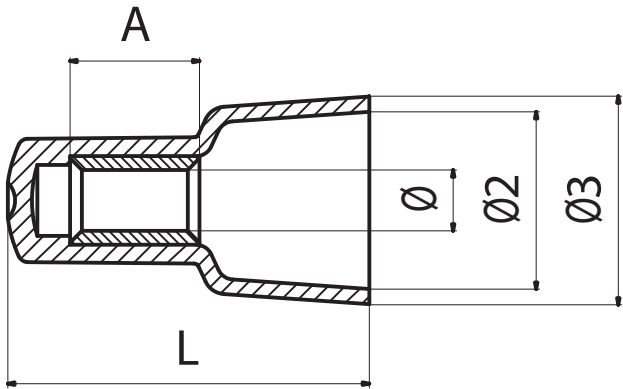

CONNECTOR SLEEVE, PRE-INSULATED WITH POLYAMIDE PA6.6, WHITE, FOR COPPER CONDUCTORS, SECTION 1,5-2,5 MMQ

Technical information	
Maximum operating temperature	115 °C
Minimum operating temperature	-20 °C
Cable section range	1.5÷2.5 mm²
Colour of jacket	White
Cable stripping length	7.5 mm
Presence of reinforcement ring	No
Easy entry	No
Anti-vibration	No
Type	single
Insulation type	full

Weight and dimensions	
Bow external diameter (Ø3)	9.5 mm
Barrel internal diameter (Ø)	3 mm
Bow internal diameter (Ø2)	7.9 mm
Barrel length (A)	6.8 mm
Sleeve length (C)	19.9 mm
Total connector length (L)	19.9 mm

Material composition and treatments	
Halogen-free	No
Insulating jacket material	Polyamide PA6.6
Conductor body material	Electrolytic copper with purity above 99,95%
Annealed	Yes
Conductor body surface treatment	tin plating
Minimum thickness of conductor body surface treatment	3 µm

Certifications and approvals	
REACH	Yes
ROHS	Yes

Logistics	
Minimum packaging unit	100
Standard packaging unit	1000