

Cable lugs > Pre-insulated > Connector sleeves

Type: NL06-PB

Family: NL-P

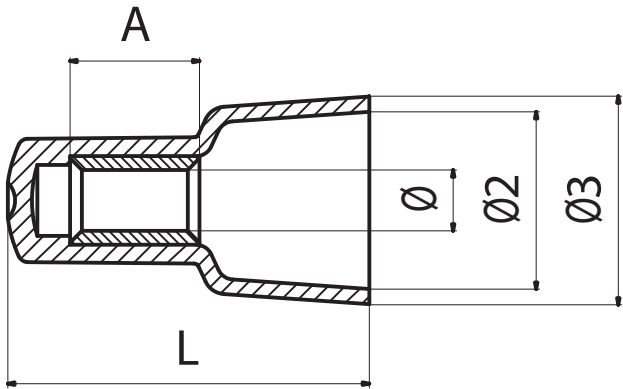

CONNECTOR SLEEVE, PRE-INSULATED WITH POLYAMIDE PA6.6, BLUE, FOR COPPER CONDUCTORS, SECTION 1,5-2,5 MMQ

Technical information	
Maximum operating temperature	115 °C
Minimum operating temperature	-20 °C
Cable section range	1.5÷2.5 mm²
Colour of jacket	Blue
Cable stripping length	6.6 mm
Presence of reinforcement ring	No
Easy entry	No
Anti-vibration	No
Type	single
Insulation type	full

Weight and dimensions	
Bow external diameter (Ø3)	8.3 mm
Barrel internal diameter (Ø)	2.42 mm
Bow internal diameter (Ø2)	6.5 mm
Barrel length (A)	6 mm
Sleeve length (C)	13.6 mm
Total connector length (L)	13.6 mm

Material composition and treatments	
Halogen-free	No
Insulating jacket material	Polyamide PA6.6
Conductor body material	Electrolytic copper with purity above 99,95%
Annealed	Yes
Conductor body surface treatment	tin plating
Minimum thickness of conductor body surface treatment	3 µm

Certifications and approvals	
REACH	Yes
ROHS	Yes

Logistics	
Minimum packaging unit	100
Standard packaging unit	1500