

Cable lugs > Pre-insulated > Connector sleeves

Type: NL03-P

Family: NL-P

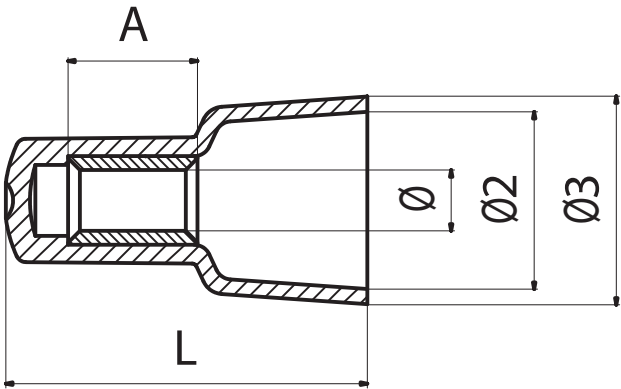

CONNECTOR SLEEVE, PRE-INSULATED WITH POLYAMIDE PA6.6, WHITE, FOR COPPER CONDUCTORS, SECTION 0,25-1,5 MMQ

| Technical information | |
|--------------------------------|--------------|
| Maximum operating temperature | 115 °C |
| Minimum operating temperature | -20 °C |
| Cable section range | 0.25÷1.5 mm² |
| Colour of jacket | White |
| Cable stripping length | 6.6 mm |
| Presence of reinforcement ring | No |
| Easy entry | No |
| Anti-vibration | No |
| Type | single |
| Insulation type | full |

| Weight and dimensions | |
|------------------------------|--------|
| Barrel internal diameter (Ø) | 2.6 mm |
| Bow internal diameter (Ø2) | 7.9 mm |
| Barrel length (A) | 6 mm |
| Sleeve length (C) | 21 mm |
| Total connector length (L) | 21 mm |

| Material composition and treatments | |
|---|--|
| Halogen-free | No |
| Insulating jacket material | Polyamide PA6.6 |
| Conductor body material | Electrolytic copper with purity above 99,95% |
| Annealed | Yes |
| Conductor body surface treatment | tin plating |
| Minimum thickness of conductor body surface treatment | 3 µm |

| Certifications and approvals | |
|------------------------------|-----|
| REACH | Yes |
| ROHS | Yes |

| Logistics | |
|-------------------------|------|
| Minimum packaging unit | 100 |
| Standard packaging unit | 1000 |